

BRANNVERNUTSTYR FIREFIGHTING EQUIPMENT

SYMBOL	ANTALL NO.S	BESKRIVELSE DESCRIPTION
	2	BRANN OG SIKKERHETSPLAN FIRE CONTROL PLAN
	3	BRANNKLOKKE BELL FIRE ALARM
	2	VARMEDETEKTOR HEAT DETECTOR
	7	PULVERAPPARAT 12 KG (5+2 RESERVE) POWDER EXTINGUISHER 12 KG
	1	BRANNØKS FIRE HOSE
	2	NØDSTENGING AV DRIVSTOFF-TILFØRSEL REMOTE CONTROL FUEL OIL VALVES
	1	FJERNSTOPP, VENTILASJON REMOTE VENTILATION SHUTOFF
	1	BRANN/SPYLE PUMPE [24 m³/h, 25 m/vs (0,25 N/mm²)] FIRE/FLUSH PUMP
	2	BRANNSLANGER FIRE HOSE
	1	BRANNHYDRANT FIRE MAIN WITH FIRE VALVES
	4	BRANNSPJELD I VENT.KANALER, MANUELT FIRE DAMPER IN VENT. DUCT, MANUAL
	3	TRYKK KNAPP FOR BRANNALARM PUSH BUTTON FOR FIRE ALARM
	1	BRANN ALARM PANEL FIRE ALARM PANEL
	7	RØYK DETEKTOR SMOKE DETECTOR
	1	BRANNTEPPE FIRE BLANKET
	1	NØDSTRØMKILDE: NØDBATTERI EMERGENCY BATTERY
	1	HORN/SIRENE FOR INERGEN ALARM HORN FOR INERGEN
	1	FJERNSTART BRANNPUMPE REMOTE CONTROL FIRE-PUMPS
	1	INERGEN BATTERI INERGEN BATTERY
	1	INERGEN UTLØSER INERGEN RELEASE STATION
	1	OMRÅDE BESKYTTET AV INERGEN GASS EXTINGUISHING SYSTEM

LIVREDNINGSUTSTYR LIFESAVING EQUIPMENT

SYMBOL	ANTALL NO.S	BESKRIVELSE DESCRIPTION
	1	FRIFLYT NØDPEILESENDER EPIRB
	2	REDNINGSFLÅTER: LIFERAFTS: 2x 6 personer.
	1	REDNINGSVESTER (6 STK.) LIFEJACKETS (6 PCS.)
	1	FØRSTEHJELPSUTSTYR MEDICAL KIT
	1	LIVBØYE MED LINE LIFEBUOY WITH LINE
	1	6 NØDRAKETTER, 6 HÅNDBLUSS 6 PARACHUTE FLARES, 6 HANDHELD FLARES
	-	HOVEDRØMNINGSVEI PRIMARY MEANS OF ESCAPE
	2	BÆRBAR NØDRADIO SURVIVAL CRAFT PORTABLE RADIO
	1	BÆRBAR FRIFLYT NØDPEILESENDER PORTABLE EPIRB
	1	REDNINGSDRAKT (6 STK.) IMMERSION SUIT (6 PCS.)
	2	LIVBØYE MED LYS OG RØYK LIFEBUOY WITH LIGHT AND SMOKE
	1	AR LØFTEBØYLE LIFE RESCUE LIFTING BOW
	1	MØNSTRINGSSTASJON MUSTER STATION
	-	NØDUTGANG EMERGENCY EXIT
	1	LINEKASTENDE APPARAT (4 liner og prosjektii) LINE THROWING APPLIANCE
	1	RADAR REFLEKTOR RADAR TRANSPONDER
	13	NØDLYS 24 V DC EMERGENCY LIGHT 24 V DC

MAIN PARTICULARS

LENGTH OVER ALL (LOA)	:	18,25 m
LENGTH BETWEEN P.P. (LPP)	:	16,55 m
BREADTH MLD	:	6,28 m
DEPTH TO MAIN DECK	:	3,49 m
SOMMER DYPGÅENDE	:	3,37 m
MAX DRAUGHT AFT	:	3,83 m
FRAME SPACING	:	0,50 m

C	Cabin details updated	23.06.21	VJ				
A	Updated after conversion 2020	21.08.20	VJ	B	Fixed firefighting containers moved	01.03.21	VJ
REV	ALTERATIONS	DATE	SIGN	REV	ALTERATIONS	DATE	SIGN
YARD NO./NAME YARD No. 20, BÅT OG MOTORSERVICE				BLOCK		CLIENT (NAME/LOGO)	
FIRE AND SAFETY PLAN MS HERMON, LLGQ				KENFISH 2 AS FLATSET 6530 AVERØY			
DEP.	MM PRO. AM123	MM DWG. NO.	SCALE	YARD DWG. NO.			
DATE August 20	APPR.	AM123-511-001	1:50				
DES.	VJ	CHK.	FILE	AM123-101-001.dwg	REV	SFI	101
Dalegaten 137 N-6518 Kristiansund, Norway Tel.: +47 71 58 30 00 E-mail: post@moremaritime.com				C 101			
more maritime				SHEET 1/1			
TO REPLACE				09-01-02			
REPLACED BY				INFO			

CAPACITIES

CARGO HOLD	:	84 m3
MAIN DECK AREA	:	48 m2
DEADWEIGHT	:	123 tonnes
FUEL OIL	:	10,2 m3
FRESH WATER	:	3 m3
GROSS TONNAGE	:	101 GT

ALL RIGHTS RESERVED!

This drawing is the property of More Maritime AS.
It may not be copied or forwarded to any third party without our written consent.
The receipt of this drawing implies that the above conditions are accepted.

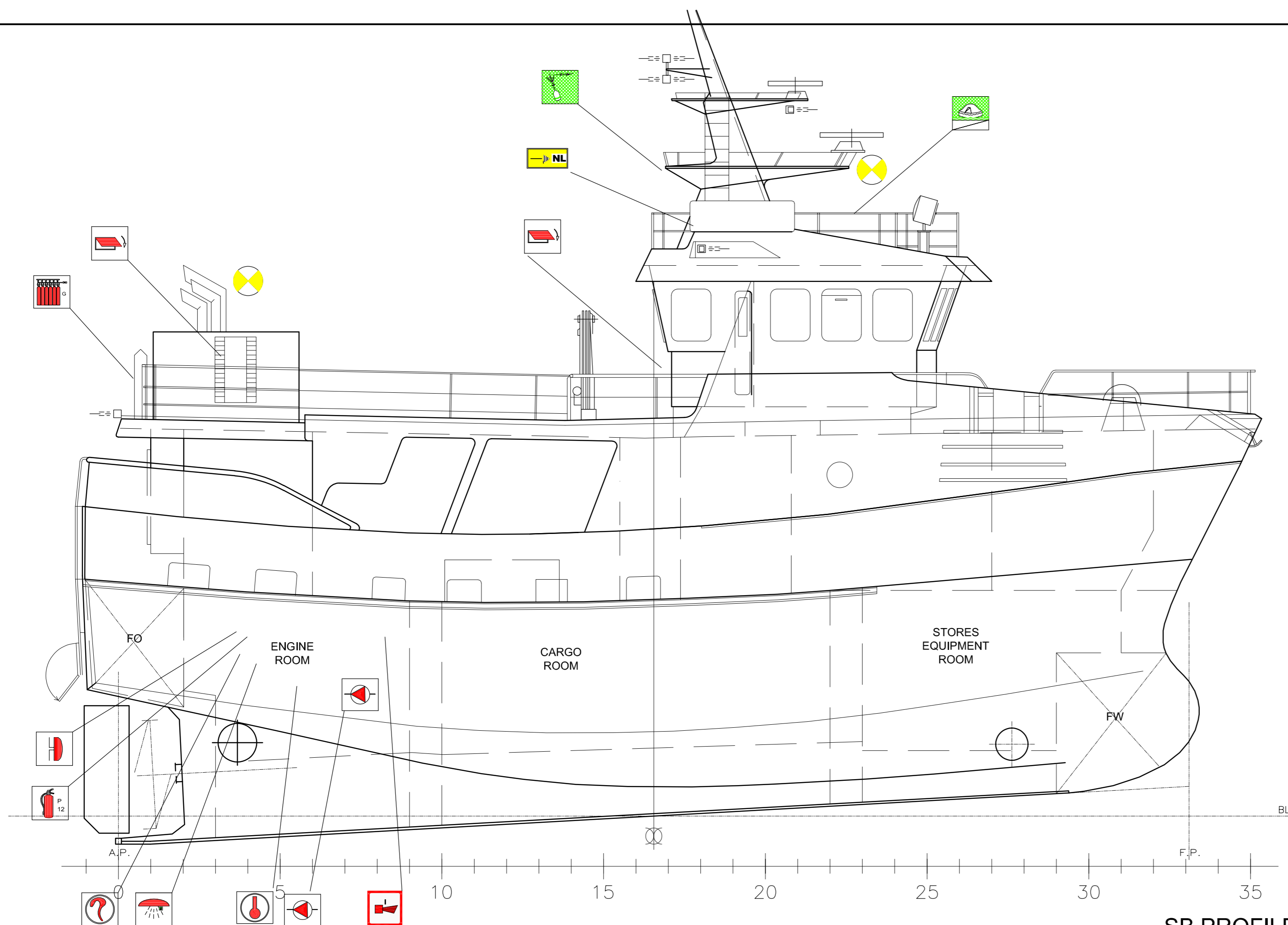

SB PROFILE

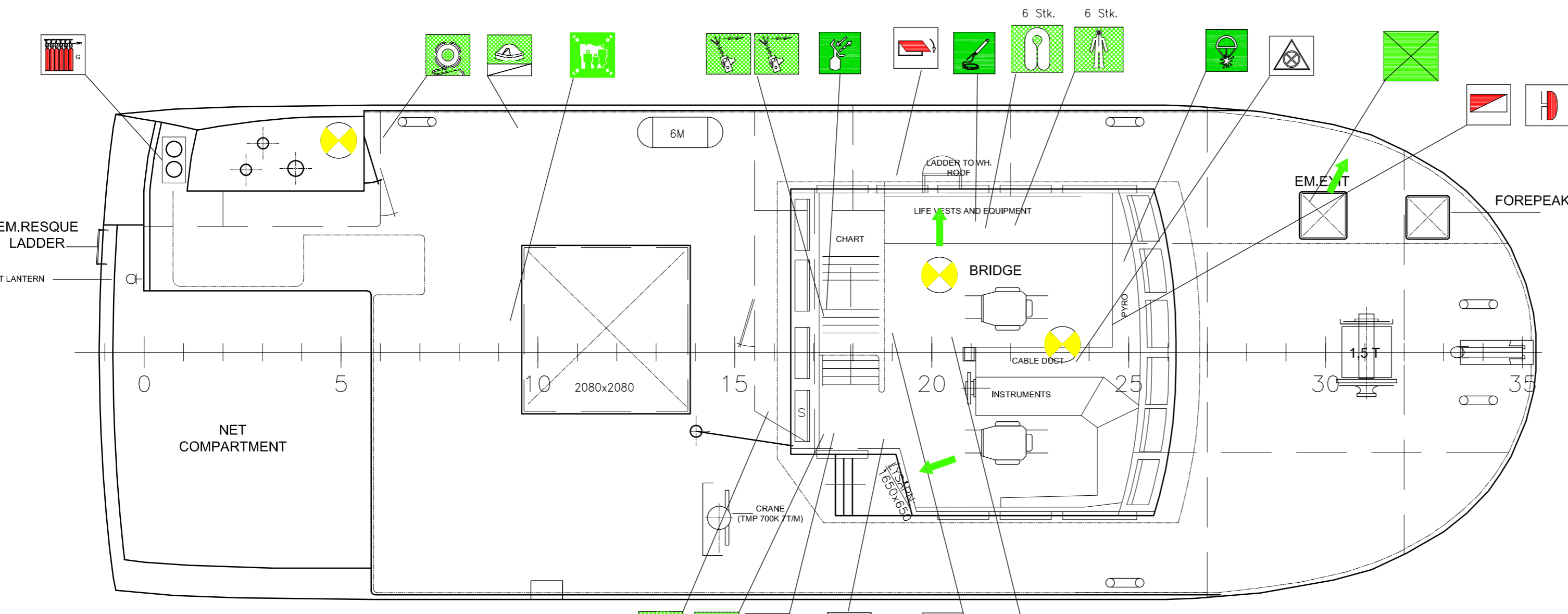

BOAT DECK/BRIDGE
6190

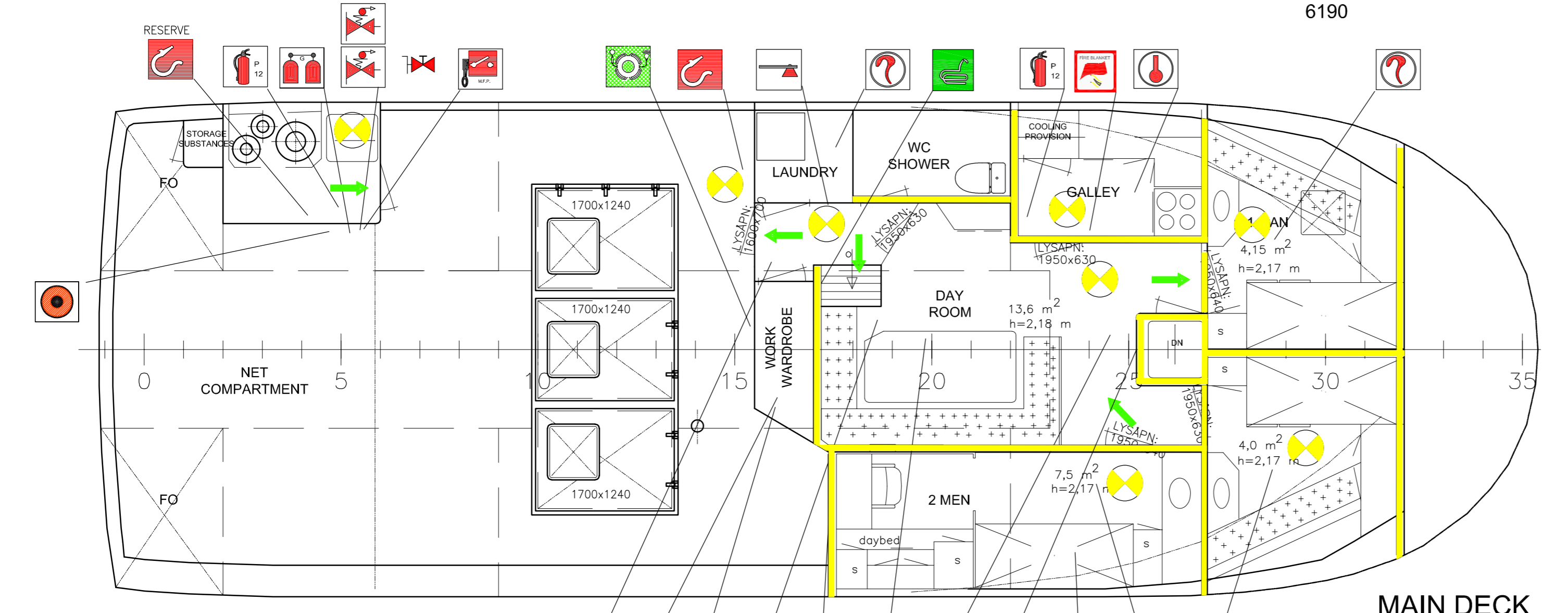

MAIN DECK
3490

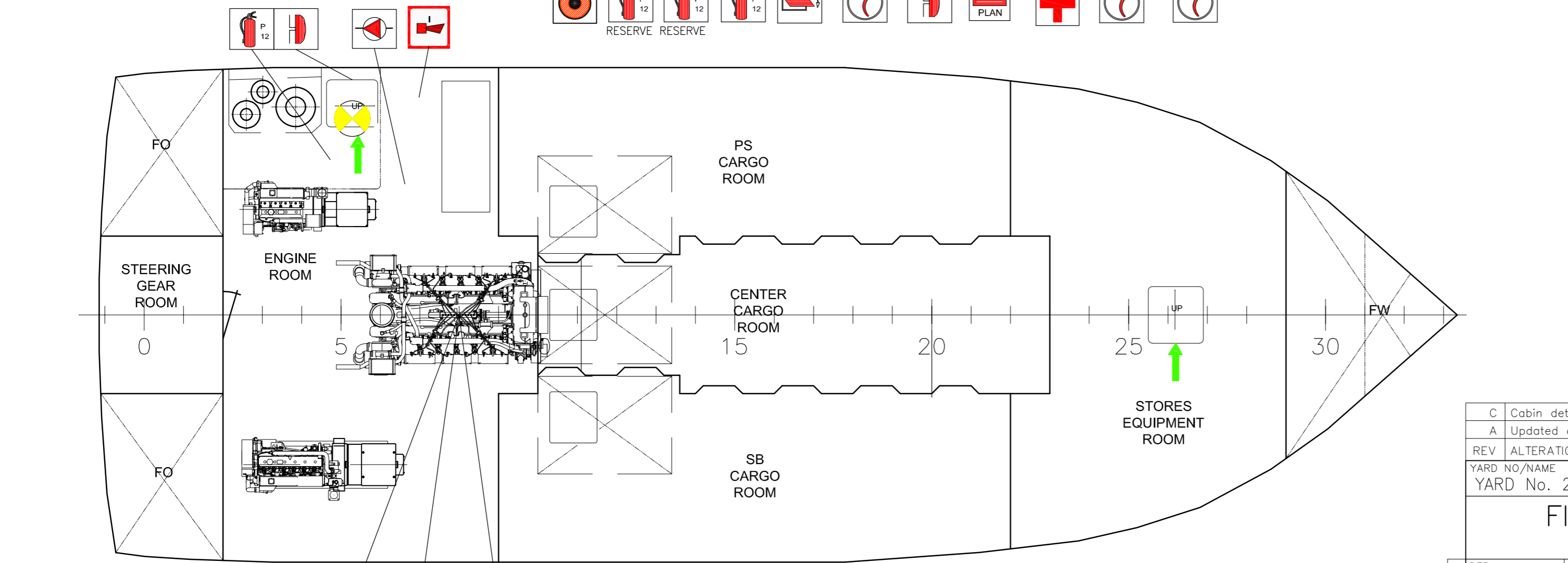

STORES EQUIPMENT ROOM

ALL RIGHTS RESERVED!

This drawing is the property of More Maritime AS.
It may not be copied or forwarded to any third party without our written consent.
The receipt of this drawing implies that the above conditions are accepted.